



**DELTA  
FIRE**



# HIGH BACK PRESSURE FIXED FOAM GENERATOR

## KEY USERS

- Petrochemicals
- Fuel Storage Sites
- Oil & Gas
- Marine
- Major Industrials
- Aviation
- Chemical Facilities
- Nuclear

## KEY FACTS

- Manufactured in the UK
- ISO9001 Quality Controlled
- High Performance 40% Back Pressure
- Fixed Flange & Threaded Models
- Flow Engineered to Suit Clients Requirements
- Harsh Environment Models
- Optional Inlet/Outlet Pressure Gauges

Doc Ref: DDS070



**DELTA FIRE**

Broadland Business Park, Norwich, Norfolk, UK, NR7 0FE

T: +44(0)1603 735000 | E: [sales@deltafire.co.uk](mailto:sales@deltafire.co.uk) | E: [export@deltafire.co.uk](mailto:export@deltafire.co.uk)  
[deltafire.co.uk](http://deltafire.co.uk)

## GENERAL DESCRIPTION

Delta **High Back Pressure Foam Generators** are designed for use in Base Injection Foam Systems and are primarily used in the protection of hydrocarbon risks in fixed roof tanks.

Designed to produce low expansion foam with an expansion of around 4:1, these Fixed Foam Generators will operate efficiently against a back pressure of up to 40% of the foam solution inlet pressure.

Supplied as standard with ANSI 150lb Flanged connections (optional NPT threaded) and manufactured from red oxide coated carbon steel, foam flow rates can be pre-engineered to provide precise application rates to suit each specific risk.

To meet the varied needs of our customers around the world we also offer stainless steel options providing enhanced corrosion resistance suited to extreme environment use.

Six models are available with flows from 600 to 2000 LPM (160 to 530 GPM) to cater for a broad range of

## TECHNICAL DATA

### Flanged Versions

Model	Dia A	Dia B	Dia C	Flow LPM	Flow GPM	Weight (kg)
DHBPG-6	2" (52mm)	3" (76mm)	24" (600mm)	600	160	13
DHBPG-8	3" (76mm)	4" (100mm)	24" (600mm)	800	210	16
DHBPG-10	3" (76mm)	4" (100mm)	24" (600mm)	1000	265	16
DHBPG-12	4" (100mm)	6" (156mm)	39" (1000mm)	1200	320	33
DHBPG-16	4" (100mm)	6" (156mm)	39" (1000mm)	1600	420	33
DHBPG-20	4" (100mm)	6" (156mm)	39" (1000mm)	2000	530	33

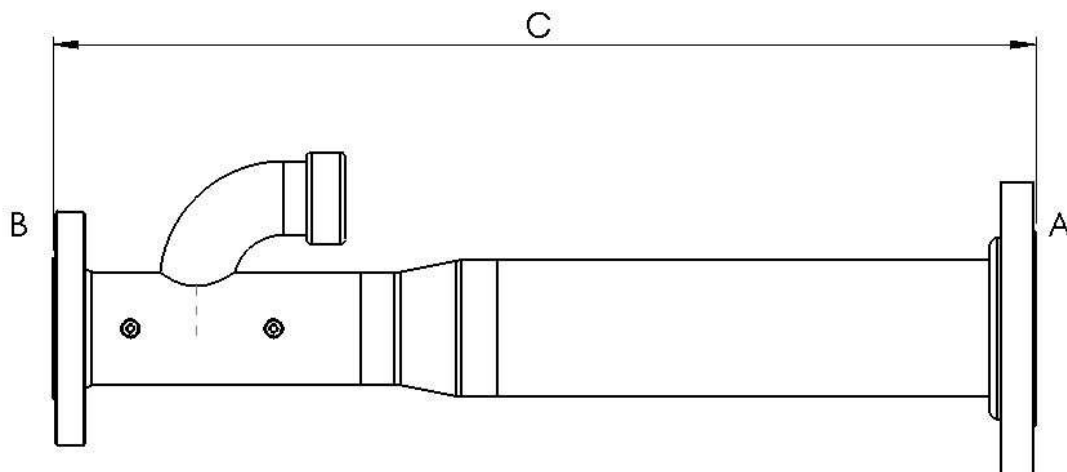

Available with NPT threaded inlet/outlet connections on request



**DELTA FIRE**

Broadland Business Park, Norwich, Norfolk, UK, NR7 0FE

T: +44(0)1603 735000 | E: sales@deltafire.co.uk | E: export@deltafire.co.uk

deltafire.co.uk