

**DELTA  
FIRE**

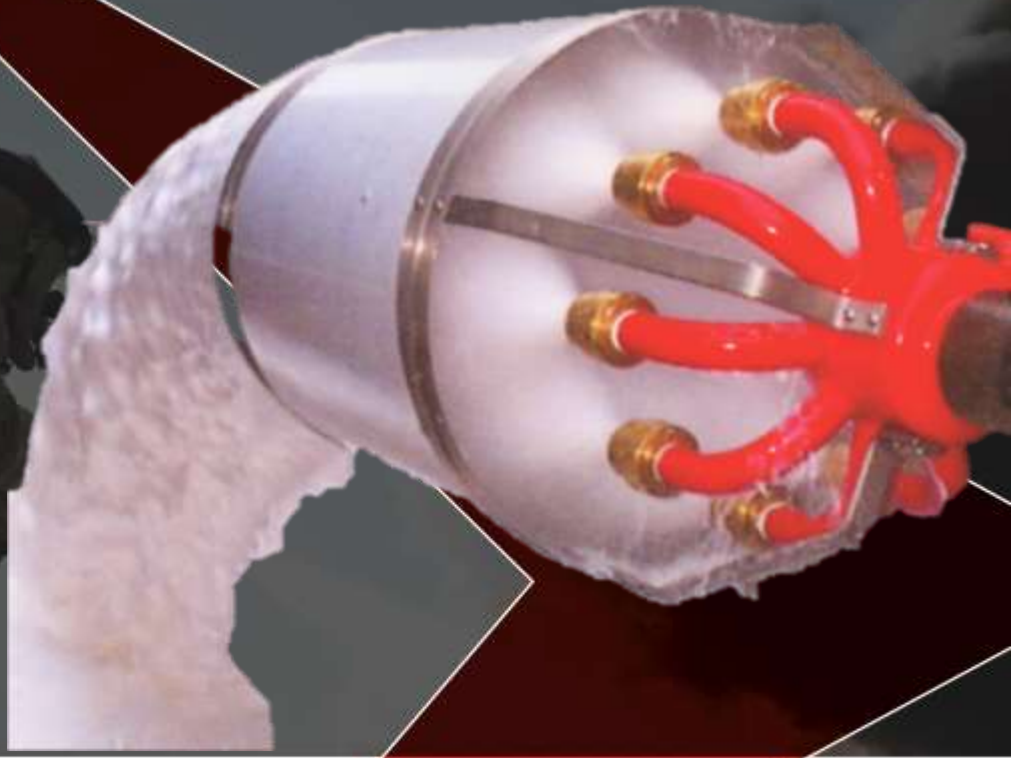

# MX-SERIES FOAM BUND POURERS

## KEY USERS

- Petrochemicals
- Fuel Storage Sites
- Oil & Gas
- Marine
- Major Industrials
- Aviation
- Chemical Facilities
- Nuclear

## KEY FACTS

- Manufactured in the UK
- ISO9001 Quality Controlled
- High Output Medium Expansion Foam Production
- Flow Engineered to suit Client
- 316 Stainless Steel Pourer Tube and Internals
- Flows from 600 litres/min to 1,800 litres/min
- Brass/Gunmetal Nozzles

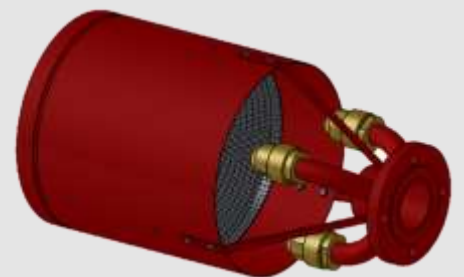

**MX Foam Bund Pourer**

Doc Ref: DDS004

**DELTA FIRE**

Broadland Business Park, Norwich, Norfolk, UK, NR7 0FE

T: +44(0)1603 735000 | E: sales@deltafire.co.uk | E: export@deltafire.co.uk

deltafire.co.uk

## **GENERAL DESCRIPTION**

Delta Medium Expansion MX Bund Pourers are designed for both fire protection systems and vapour suppression in bunded or diked areas surrounding flammable liquid or toxic chemical storage tanks. They are also ideally suited to other applications where large volumes of free flowing foam are required such as Process Areas, Warehouses and Cable Ductings etc. A fire in a bunded area can escalate extremely quickly and spread to adjacent storage vessels if not quickly controlled. A leak of un-ignited fuel from a faulty valve, cracked pipe or overfill can threaten the entire installation facility in a very short timeframe.

Delta's MX Bund Pourers are designed to produce large volumes of medium expansion foam quickly and efficiently securing the bunded area from threat of ignition or toxic vapour release.

The MX Bund Pourer range consists of three lightweight, compact and robust options in nominal flows of 600, 1200 & 1800 litres per minute but can be flow-engineered to bespoke requirements to provide the correct application rate and optimum system cost.



Designed and Manufactured by Delta Fire in the UK the MX Bund Pourer range is built to exacting standards under an ISO9001 Quality Management Standard from top quality materials.

Offering bespoke flow engineering to meet each customer's specific requirements the Delta MX Series of Foam Bund Pourers are widely used across a broad range of Industry sectors globally providing high performance, cost-effective protection of stored flammable liquids.

Delta's team of highly experienced design engineers boast a wealth of accumulated knowledge in the production of world class fixed foam firefighting products and are on hand to offer advice and technical support to ensure every brief is met fully.



### **DELTA FIRE**

Broadland Business Park, Norwich, Norfolk, UK, NR7 0FE

T: +44(0)1603 735000 | E: [sales@deltafire.co.uk](mailto:sales@deltafire.co.uk) | E: [export@deltafire.co.uk](mailto:export@deltafire.co.uk)

[deltafire.co.uk](http://deltafire.co.uk)

## GENERAL DESIGN

The Delta MX Series of Bund Pourers are the culmination of extensive design and development work over many years resulting in a superior, high performance range suited to a wide spectrum of applications around the world. With an operating pressure range of between 1.5 & 3 bar and flow ranges of 600, 1200 & 1800 litres per minute the Pourers provide typical foam outputs of up to 90 M<sup>3</sup> per minute (MX1800).

Model	MX600	MX1200	MX1800
K Factor*	380	759	1138
Operating Pressure Range	1.5 to 3 bar		
Optimum Flow Rate @ 2.5 Bar Inlet Pressure	600 l/min	1200 l/min	1800 l/min
Typical Expansion ratio	50:1		
Typical Foam Output @ 2.5 Bar Inlet Pressure	30 M <sup>3</sup> per minute	60 M <sup>3</sup> per minute	90 M <sup>3</sup> per minute

\*Flow (litres per minute) = KVP where P = Pressure in Bar.

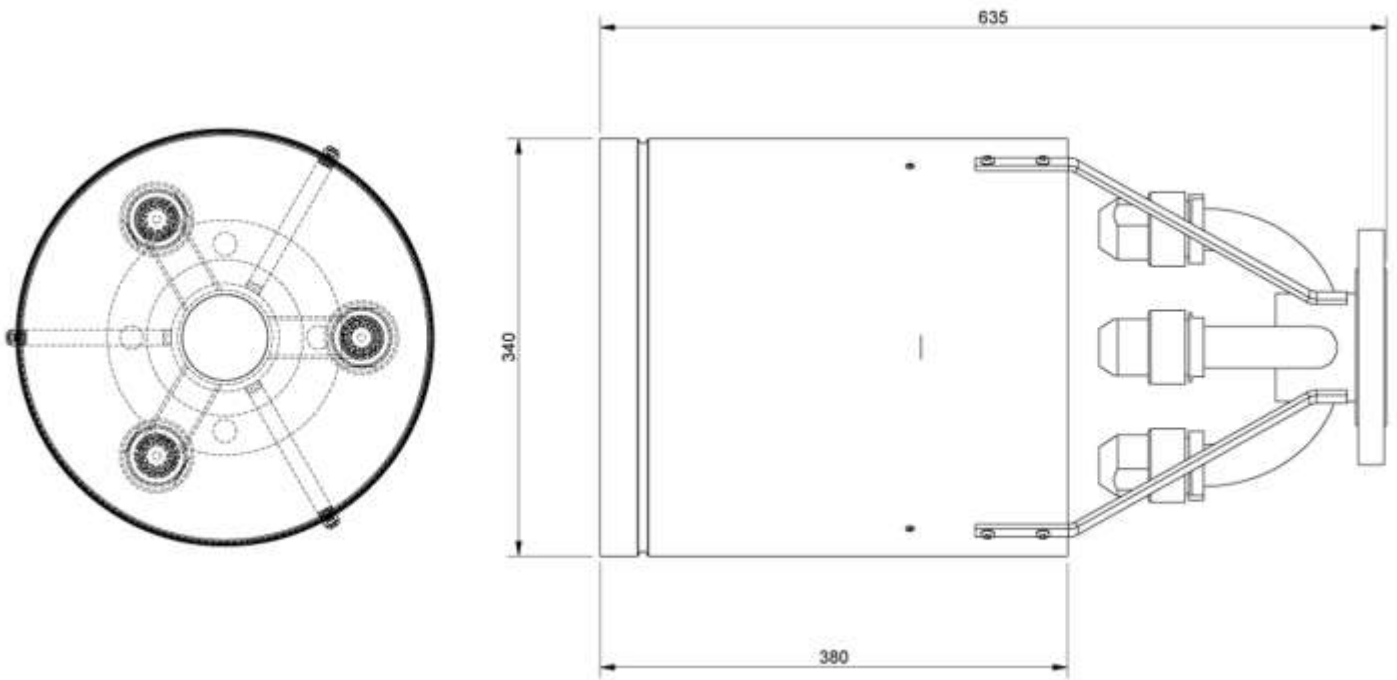

## BESPOKE MANUFACTURING

As standard the MX Series are supplied with the Pourer Tubes in natural finish 316 stainless steel with International Orange powder coated Pipework Spider however alternative paint finishes to the tube and spider are available on request.



**DELTA FIRE**

Broadland Business Park, Norwich, Norfolk, UK, NR7 0FE

T: +44(0)1603 735000 | E: sales@deltafire.co.uk | E: export@deltafire.co.uk

deltafire.co.uk

## THE RANGE

The Delta Foam Bund Pourers are available in three basic models with flow rates ranging from 600 to 1800 litres per minute. Whilst our standard range fulfils the criteria of the vast majority of our customers we also appreciate that there are often bespoke variations of our Pourers required to fulfil a specific design or installation brief. As our range is manufactured by us in the UK we have the unique ability to fabricate and flow engineer our Pourers to suit individual customer needs, tailored specifically to protect the risk requiring protection.

Delta Fire manufactures their products under an ISO9001 Quality Management System ensuring the very highest standards of quality and performance are met at all times. Rigorous multi-stage QA assessment and testing guarantees that every Poured is flow-engineered correctly.

Delta Fire only use high quality, certificated materials in the construction of our products and are pleased to offer fully traceable Western sourced materials where specified within a project design specification.

Product Code	FEF00600	FEF001200	FEF001800
Model	MX600	MX1200	MX1800
Overall Length (mm)	635	900	920
Pourer Tube Length (mm)	380	570	648
Width (mm)	305	420	520
Inlet (Flanged Option)	2" BSP Male	2½" BSP Male	3" BSP Male
Pipework Spider	Carbon Steel – International Orange Powder Coated		
Nozzles	Brass/Gunmetal Natural Finish		
Pourer Tube	316 Stainless Steel		
Internals	316 Stainless Steel		
Screws / Nuts & Washers	316 Stainless Steel		

Individual Performance Curves are available on request for each of the 3 models. Every Delta Foam Bund Poured is factory calibrated to produce an optimised flow/pressure characteristic.



### DELTA FIRE

Broadland Business Park, Norwich, Norfolk, UK, NR7 0FE

T: +44(0)1603 735000 | E: sales@deltafire.co.uk | E: export@deltafire.co.uk

deltafire.co.uk